

NORWEGIAN PEARL

Category Descriptions

Deck Plans

Staterooms

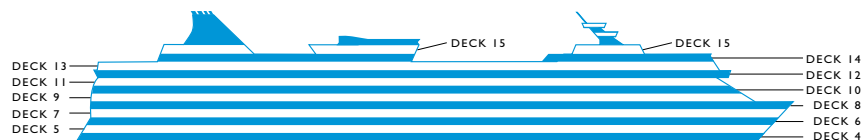

Built: 2006 **Gross Tonnage:** 93,000 **Overall Length:** 965 feet
Beam: 105 feet **Draft:** 27 feet **Engines:** Diesel Electric
Cruise Speed: 25 knots **Guests:** 2,394 (double occupancy) **Crew:** 1,087

Garden Villa Deck 14 **S1**

These amazing Villas sleep up to eight with three separate bedrooms, each with a king- or queen-size bed and luxury bath. With a living room, dining room and incredible private garden with hot tub, you will have more than enough space to spread out and unwind. You'll also have access to the private courtyard area. Includes butler and concierge service.

Deluxe Owner's Suite with Large Balcony

Deck 15 **S2**

Enjoy the perfect escape in the Deluxe Owner's Suites. With a living room, dining room, wall of windows and separate bedroom with king-size bed and luxury bath, you will have an unforgettable experience in this suite. Sleeps up to two and includes access to the private courtyard area. Not to mention the large balcony and amazing view. Includes butler and concierge service.

Owner's Suite with Large Balcony

Decks 9, 10 **S3**

These Owner's Suites are a truly luxurious way for you to get away. They include a separate bedroom with a king-size bed and luxury bath with separate shower, in addition to the living room, dining room and large private balconies with incredible views. Sleeps up to two and guests receive access to the private courtyard area. Includes butler and concierge service.

Courtyard Villa with Balcony Deck 14 **S4**

Up to six guests can enjoy these Villas that are perfect if you want to bring the kids. They have one bedroom with a queen-size bed and a luxury bath and shower, as well as a separate children's bedroom. Also features a living area, dining area and private balcony. You will also have access to the private courtyard area. Includes butler and concierge service.

Courtyard Penthouse with Balcony

Deck 14 **S5**

These Courtyard Penthouses make for an amazing cruising experience. They sleep three, with a bedroom featuring a queen-size bed, luxury bath and shower and additional bedding to sleep one more guest. Also features a living area, dining area, private balcony and access to the private courtyard area. Includes butler and concierge service.

Family Penthouse with Balcony Deck 11 **SC**

These Penthouses are perfect for your whole family. Up to six guests can stay in these luxurious Penthouses that include a bedroom with a queen-size bed and a separate children's bedroom. In addition to the living area, dining area, private balcony and luxury bath with separate shower. Includes butler and concierge service.

Penthouse with Large Balcony

Decks 9, 10 **SE**

These incredible Penthouses sleep two, with a bedroom with queen-size bed and luxury bath and shower. Also includes a living area, dining area and large private balcony that offers an amazing view. Includes butler and concierge service.

Penthouse with Large Balcony

Decks 8, 9, 10 **SF**

Perfect for a romantic getaway, you will fall head over heels for these fabulous Penthouses. They sleep two, with a bedroom with queen-size bed and luxury bath and shower, in addition to the living area, dining area and large private balcony. Includes butler and concierge service.

Aft-Facing Mini-Suite with Balcony

Deck 11 **M1**

These Mini-Suites sleep up to four guests, making them ideal if you want to bring the kids. They have two lower beds that convert into a queen-size bed as well as a sitting area, luxury bath with shower and additional bedding to sleep two more guests. Because they are aft-facing suites, the view from your private balcony is truly amazing.

Mid-Ship Mini-Suite with Balcony Deck 11 **MA**

With room for up to four guests, you'll love these Mini-Suites. They include two lower beds that convert into a queen-size bed as well as a sitting area, luxury bath with shower, additional bedding to sleep two more guests and a private balcony with a great view. Because they are mid-ship, you'll have easy access to everything on board.

Mini-Suite with Balcony Deck 11 **MB MX**

Up to four guests can stay in these Mini-Suites that come with a sitting area, luxury bath with shower, two lower beds that convert into a queen-size bed and additional bedding to sleep two more guests. Not to mention you'll have a private balcony to enjoy the incredible view.

Aft-Facing Balcony Decks 8, 9, 10 **B1**

You'll enjoy every inch of these staterooms, with enough space to sleep up to four guests. The two lower beds can be converted into a queen-size bed and the convertible sofa pulls out to sleep two more. You'll also have a sitting area and floor-to-ceiling glass doors that open to a private balcony. Because these are aft-facing, the view from your balcony is amazing and truly unforgettable.

Family Balcony Decks 8, 9, 10 **B2**

These staterooms are perfect if you want to bring the whole family. With room for up to four guests, there are two lower beds that convert into a queen-size bed and a convertible sofa sleeps two more. Also includes a sitting area and floor-to-ceiling glass doors that open to a private balcony.

Family Balcony Decks 8, 9 **B3**

These connecting staterooms are great family accommodations. You can bring the whole family, with room for up to four guests. They feature two lower beds that convert into a queen-size bed and a convertible sofa to sleep two more, as well as a sitting area and floor-to-ceiling glass doors that open to a private balcony.

Mid-Ship Balcony Decks 9, 10 **BA**

These mid-ship staterooms sleep up to four guests and come with two lower beds that convert into a queen-size bed and a convertible sofa pulls out to sleep two more. Also includes a sitting area and floor-to-ceiling glass doors that open to a private balcony with a great view. Because they are mid-ship, you'll have easy access to everything on board.

Balcony Decks 8, 9, 10 **BB BC BD BX**

These staterooms sleep up to four guests and come with two lower beds that convert into a queen-size bed and a convertible sofa pulls out to sleep two more. They include a sitting area and floor-to-ceiling glass doors that open to a private balcony.

Family Oceanview Picture Window

Deck 5 **O1**

You can comfortably fit up to four guests in these staterooms, making them perfect for families. You'll enjoy an amazing view from the big picture window. Two lower beds convert into a queen-size bed and pull down beds sleep two more.

Oceanview Picture Window Deck 8 **OA**

These Oceanview Staterooms have enough room for up to three guests. They include two lower beds that convert into a queen-size bed and a pull down bed that accommodates an additional guest. You'll also have an amazing view to enjoy from your big picture window.

Mid-Ship Oceanview Picture Window

Up to three guests can stay in these Oceanview Staterooms. They include two lower beds that convert into a queen-size bed and a pull down bed that can sleep one more, as well as a picture window to enjoy the view. These staterooms are mid-ship accommodations, which means you'll have easy access to everything on board.

Oceanview Picture Window Deck 5 **OC**

These Oceanview Staterooms are lower deck accommodations and can sleep up to three guests. They include two lower beds that convert into a queen-size bed and a pull down bed that accommodates one more guest, in addition to the big picture window.

Mid-Ship Oceanview Porthole Window

Decks 4, 5 **OF**

Up to four guests can stay in these Oceanview Staterooms. They include two lower beds that convert into a queen-size bed and pull down beds that sleep two more, as well as a porthole to enjoy the view. These staterooms are mid-ship accommodations, which means you'll have easy access to everything on board.

Oceanview Porthole Window Decks 4, 5 **OG**

Up to four guests can stay in these Oceanview Staterooms. They include two lower beds that convert into a queen-size bed and pull down beds that sleep two more, as well as a porthole to enjoy the view.

Obstructed Oceanview Deck 8 **OK OX**

These Oceanview Staterooms sleep up to four guests and have either a picture window or porthole, with an obstructed view. Two lower beds that convert into a queen-size bed and pull down beds sleep two more.

Family Inside Decks 8, 9, 10, 11 **I1**

These Inside Staterooms are the most affordable way for your family to cruise. With room for up to four guests, you'll have two lower beds that convert into a queen-size bed and pull down beds sleep two more.

Mid-Ship Inside Decks 8, 9, 10, 11 **IA IB**

With room for up to four guests, these Inside Staterooms come with two lower beds that convert into a queen-size bed and pull down beds to accommodate two more. These staterooms are mid-ship, so you'll have easy access to everything on board.

Mid-Ship Inside Decks 4, 5 **IE**

These Inside Staterooms are on lower decks and are mid-ship accommodations. You'll have easy access to everything on board, and room for up to four guests. Includes two lower beds that convert into a queen-size bed and pull down beds to sleep two more.

Inside Decks 4, 5, 8, 9, 10, 11

IC ID IF IX

These Inside Staterooms are the most affordable way to cruise. There's room for up to four guests and they include two lower beds that convert into a queen-size bed.



LUXUSNÉPLAVBY.SK

■ Stateroom with facilities for the disabled
(For information, contact NCL Reservations.)
-- Connecting staterooms

▲ Third person occupancy available
+ Third and/or fourth person occupancy available

★ Third, fourth and/or fifth person occupancy available
☆ Up to sixth person occupancy available

× Elevator
RR Restroom

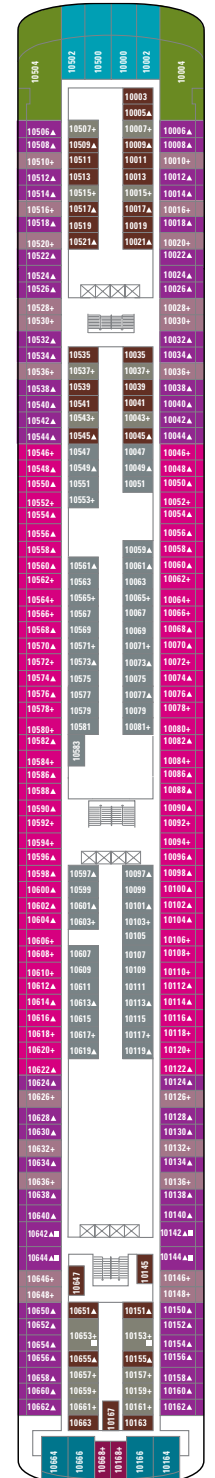
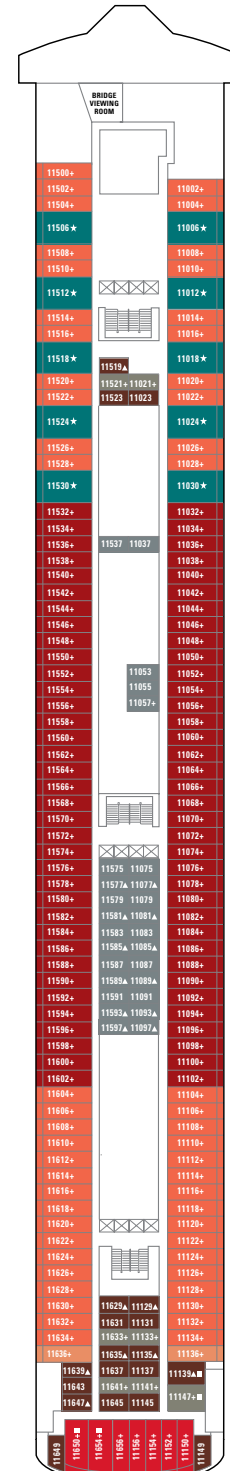
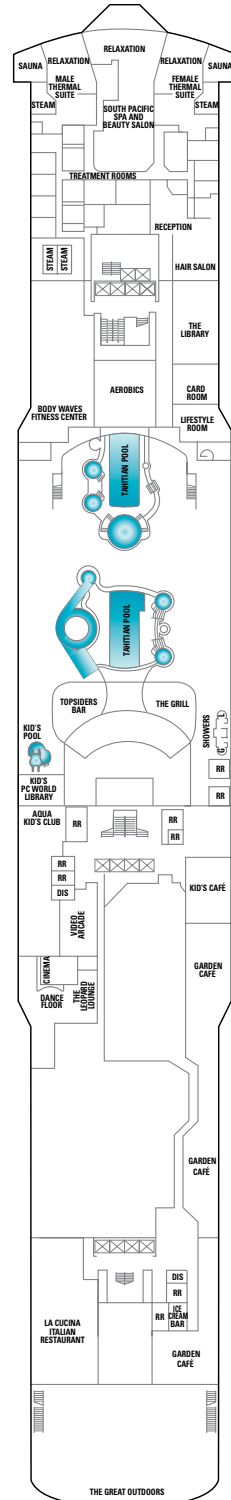
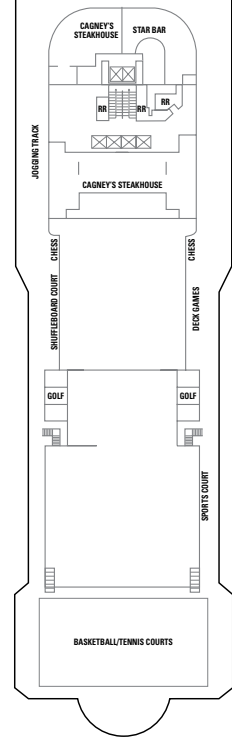
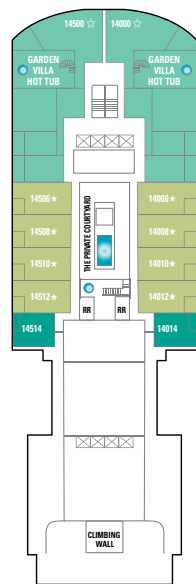
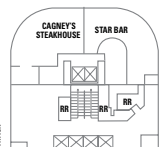
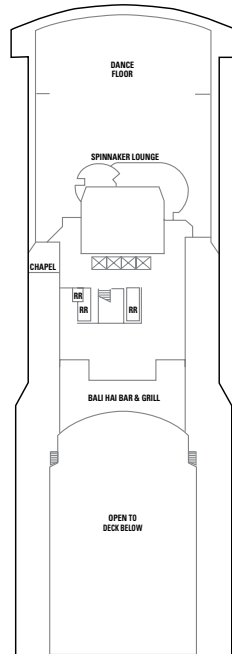
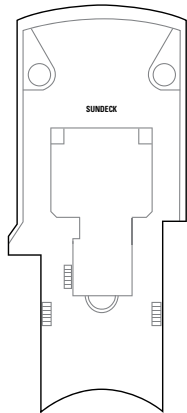
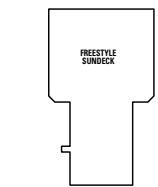

Deck 15

Deck 14

Deck 13

Deck 12

Deck 11

Deck 10

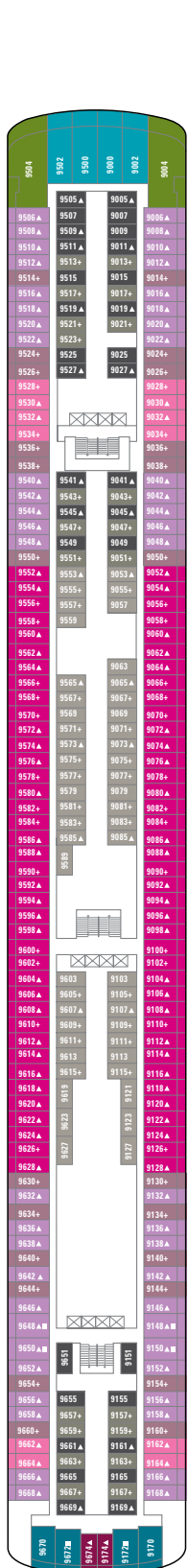

Deck 9

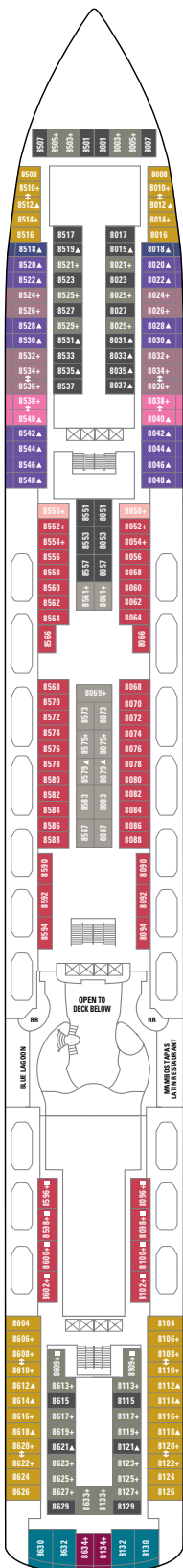

Deck 8

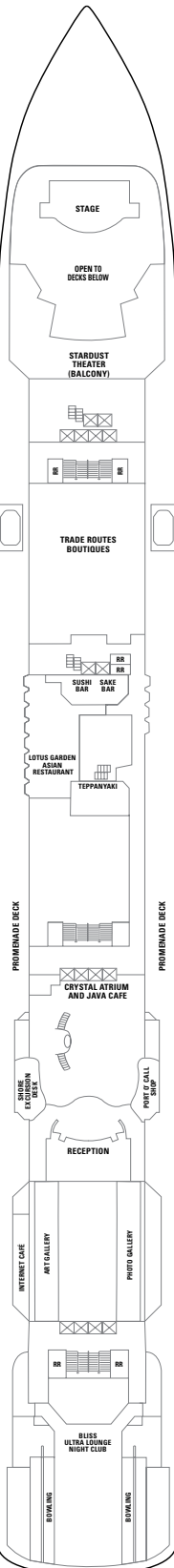

Deck 7

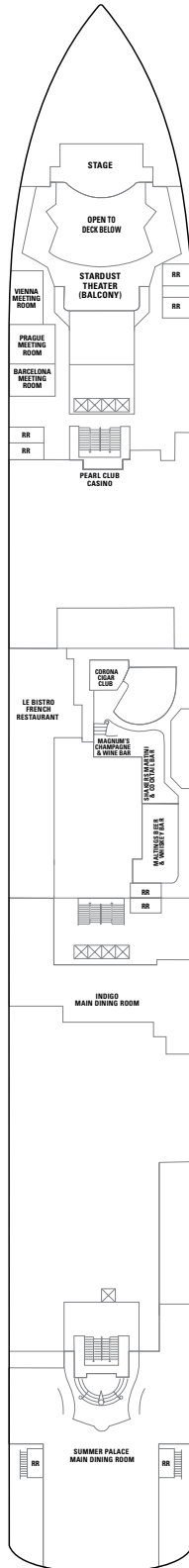

Deck 6

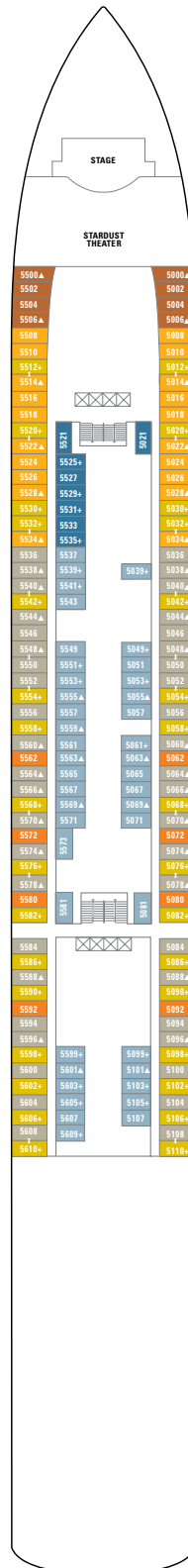

Deck 5

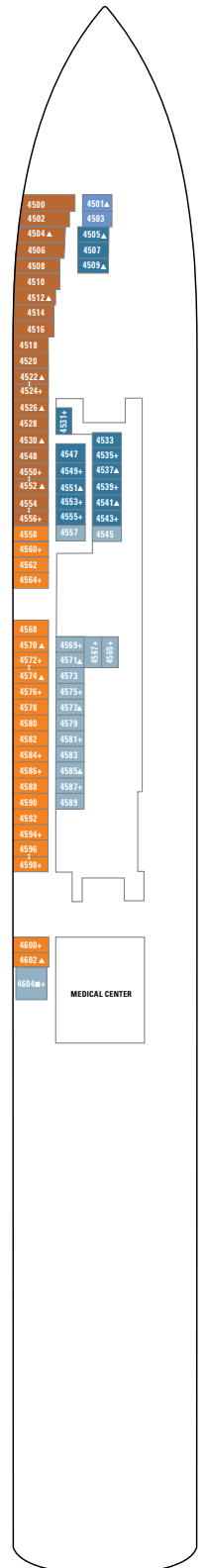

Deck 4

NORWEGIAN PEARL

Garden Villa
Category S1



Deluxe Owner's Suite with Large Balcony
Category S2



Owner's Suite with Large Balcony
Category S3



Courtyard Villa with Balcony
Category S4



Mini-Suite with Balcony
Categories M1, MA, MB, MX

